

DATASHEET

**200-103** Plain Chamfered Demarcation Stud, 40mm



**Above.** Shown with machined polished finish

**Description**

Manufactured from 316 Stainless steel.  
Machined polish finish as standard.  
Constructed from non corrosive material.  
Long Service life.  
Comes with a chamfered edge and smooth top.

**Dimensions**

40mmø x 4mm thick top  
M10 thread

**Options**

Diameter option : 15mm - 120mm

**Material Options**

Brass - Aluminium - Bronze - 304 S/S

**Fixing Pin Options**

Self adhesive - Welded pin - Machined pin - No pin

**Finishing Options**

Burnt - Bright polish - Sandblasted - Engraving - Laser etching

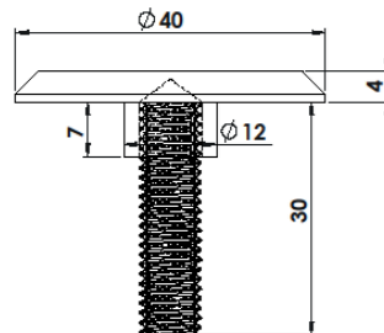
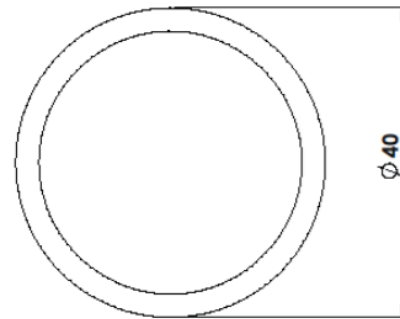

**Full installation service - POA**



**200-103 Chamfered Demarcation Stud, 40mm**

## Installation

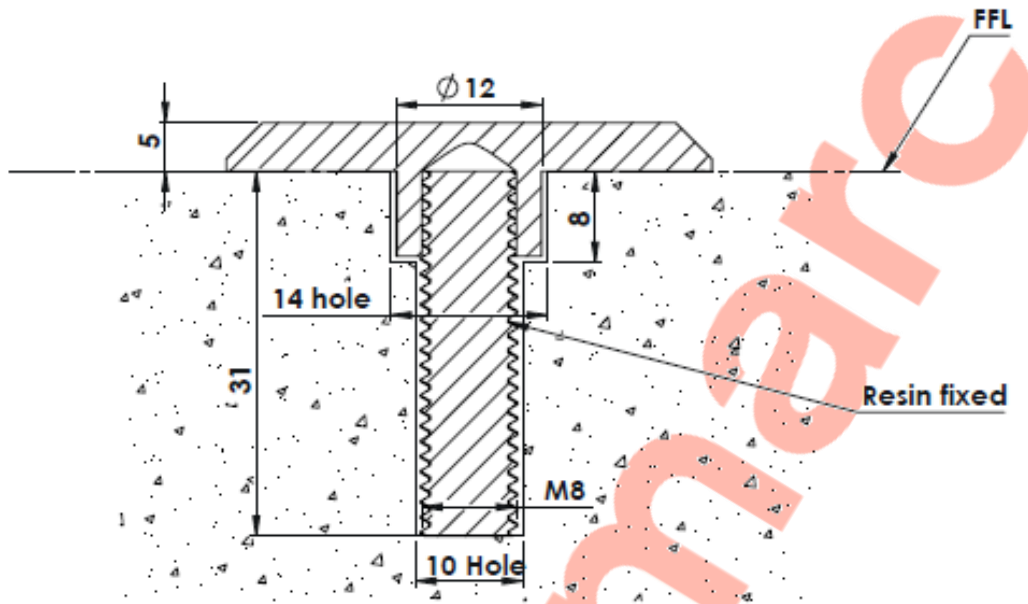
**Installation**

1. Drill hole 10mm in diameter to the depths shown above.
2. Drill holes M14 in diameter to the depths shown above.
3. Remove dust and debris caused by drilling.
4. Following the product guidelines heat the Polymer Modified Adhesive and pour a sufficient amount to fill the drilled hole.
5. Push the stud into the hole firmly ensuring an edge seal around the entire stud
6. Allow a few minutes for the Polymer Modified Adhesive to set.

**Cleaning & Maintenance**

*This product is designed for all weather exposure requiring only minimal maintenance as detailed below.*

Stainless Steel: Manufactured from premium Stainless Steel. Maintenance free, inspect fixing every 6 months. Add additional adhesive where required.

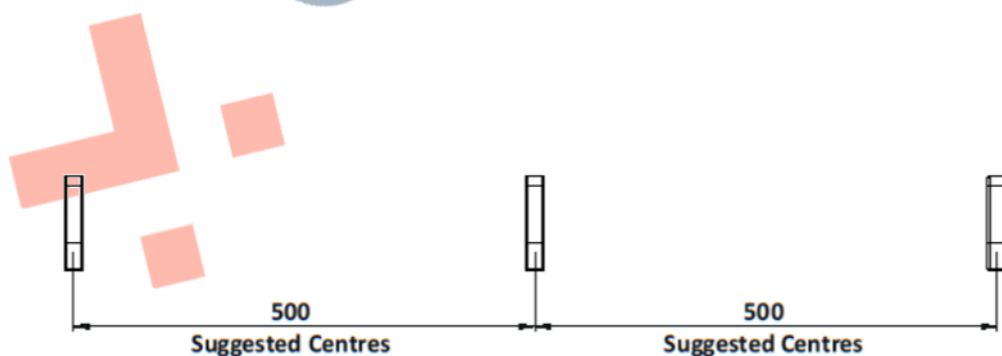

DATASHEET

**200-103** Plain Chamfered Demarcation Stud, 40mm

