

107-101 Sphere Anti-skate Stud

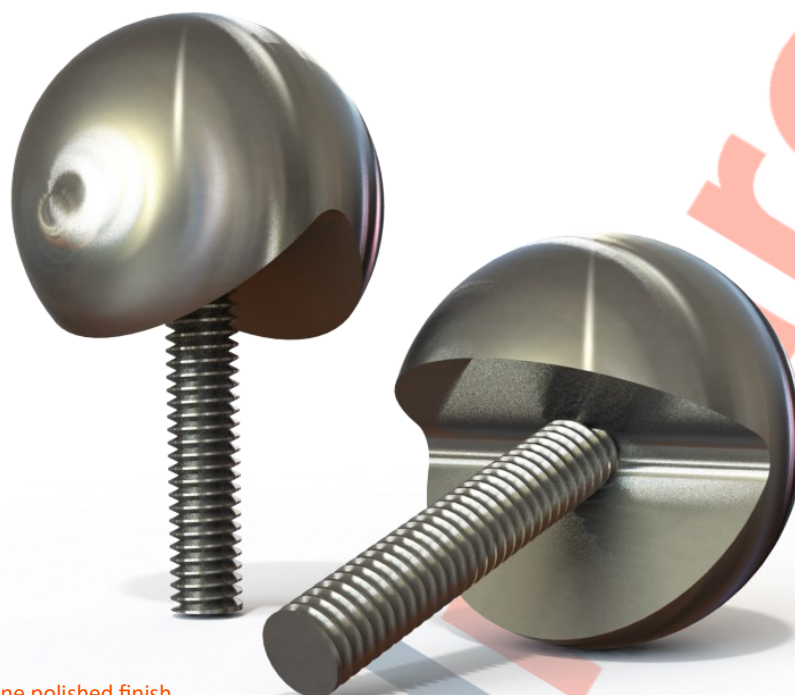

Above. Shown with machine polished finish

Description

Manufactured from 316 grade steel. Satin polish finish as standard. Constructed from non corrosive material. M8 x 40mm stud to be resin fixed to concrete, stone or timber.

Dimensions

Ø35 x 57.5mm (L)

39mm Forward protrusion

4mm Radius standard

Options

Specify required internal radius to suit edge of base product

304 Grade stainless steel

Mirror polish finish

Bespoke sizing

Full installation service

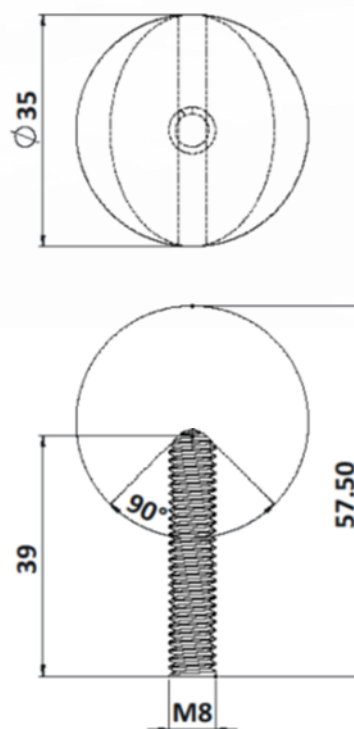

107-101 Sphere Anti-skate Stud Installation

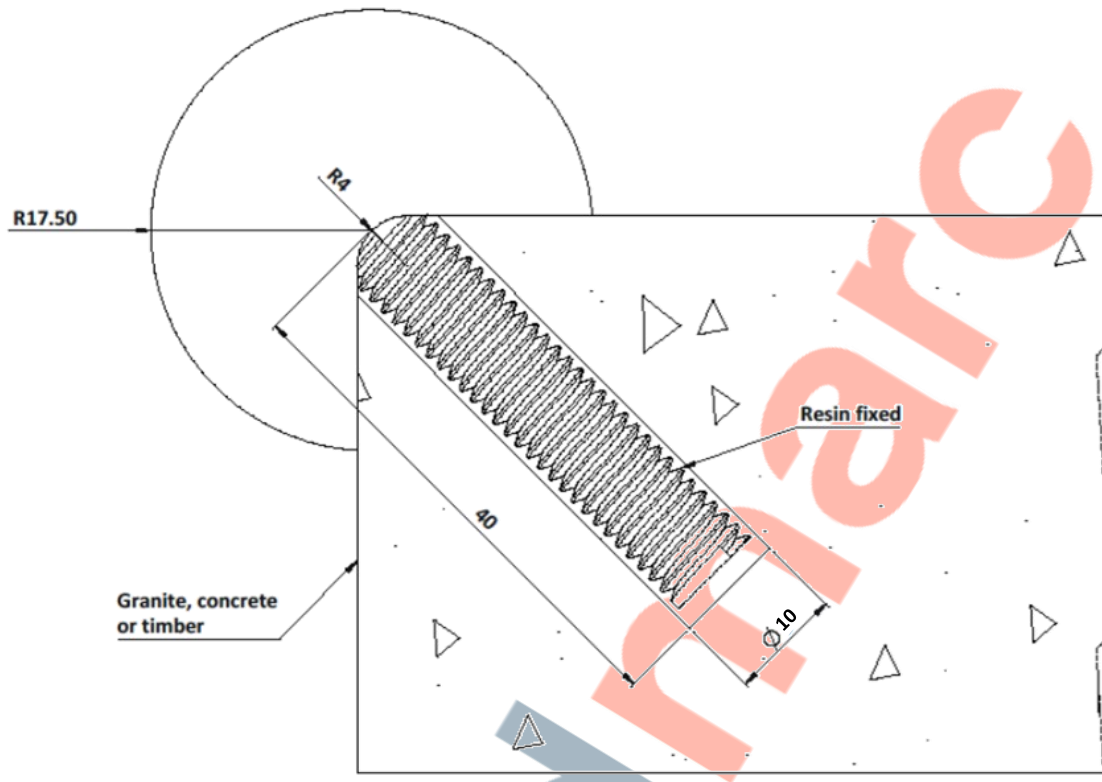

Installation

1. Drill holes 10mm in diameter to the depths shown above at a 45 deg. angle.
2. Remove dust and debris caused by drilling.
3. Following the product guidelines heat the Polymer Modified Adhesive and pour a sufficient amount to fill the drilled hole.
4. Push the stud into the hole firmly ensuring an edge seal around the entire stud
5. Allow a few minutes for the Polymer Modified Adhesive to set.

Cleaning & Maintenance

This product is designed for all weather exposure requiring only minimal maintenance as detailed below.

Stainless Steel: Manufactured from premium grade stainless steel. Maintenance free, inspect fixing every 6 months. Add additional Adhesive where required.

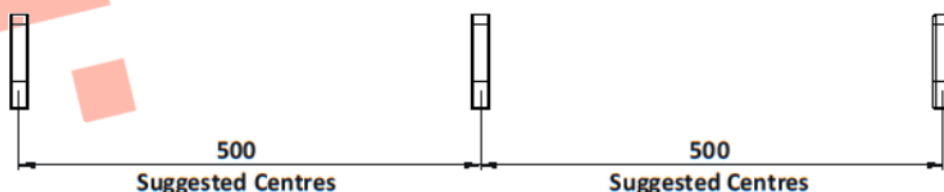

DATASHEET

107-101 Sphere Anti-skate Stud

